

**DESCRIZIONE / DESCRIPTION**

Valvola di ritegno universale in ottone, serie planet

**FOTO / PICTURE**

*Universal brass check valve, planet series*



**CARATTERISTICHE / FEATURES**

- corpo, in ottone CW617N
- molla in acciaio inox AISI 302.
- otturatore in Ottone con guarnizione tenuta in gomma NBR
- finitura sabbiata e tornita
- filettature ISO 228/1
- 25-16-10 Bar – temperature min-max. –20°C +100°C
- Installazione su tubazioni orizzontali e/o verticali
- brass “CW617N” body.
- stainless steel AISI 302 spring.
- Brass inner disk valve with NBR rubber gasket.
- sand-blasted and machined finishing.
- threading to ISO 228/1.
- 25-16-10 Bar – temperature min-max. –20°C+100°C
- Fitting up to horizontal and vertical pipe

**DIMENSIONI PRINCIPALI / LEADING DIMENSIONS**

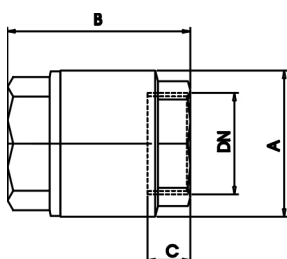

| DN" | 1/2 | 3/4 | 1  | 1 ¼ | 1 ½ | 2   | 2 ½ | 3   | 4   |
|-----|-----|-----|----|-----|-----|-----|-----|-----|-----|
| A   | 35  | 41  | 48 | 60  | 69  | 87  | 105 | 114 | 146 |
| B   | 57  | 64  | 74 | 82  | 92  | 101 | 115 | 121 | 124 |
| C   | 11  | 13  | 17 | 18  | 19  | 21  | 22  | 24  | 26  |

**PRESSIONI DI ESERCIZIO A MAX 80°C / WORKING PREASSURES AT 80°C**

|       |      |      |      |    |      |      |    |      |    |    |            |
|-------|------|------|------|----|------|------|----|------|----|----|------------|
| PN 40 |      |      |      |    |      |      |    |      |    |    | p.s.i. 600 |
| PN 32 |      |      |      |    |      |      |    |      |    |    | p.s.i. 435 |
| PN 25 |      | *    | *    | *  |      |      |    |      |    |    | p.s.i. 350 |
| PN 20 |      |      |      |    |      |      |    |      |    |    | p.s.i. 300 |
| PN 16 |      |      |      |    | *    | *    | *  |      |    |    | p.s.i. 250 |
| PN 10 |      |      |      |    |      |      |    | *    | *  | *  | p.s.i. 150 |
|       | 3/8" | 1/2" | 3/4" | 1" | 1 ¼" | 1 ½" | 2" | 2 ½" | 3" | 4" |            |

**PRESSIONE MIN. APERTURA / MIN. OPENING PRESSURE**

|      |  |  |     |     |    |     |     |    |      |      |      |
|------|--|--|-----|-----|----|-----|-----|----|------|------|------|
| R"   |  |  | 1/2 | 3/4 | 1  | 1 ¼ | 1 ½ | 2  | 2 ½  | 3    | 4    |
| mbar |  |  | 90  | 50  | 30 | 20  | 12  | 12 | n.d. | n.d. | n.d. |

**PERDITE DI CARICO / PRESSURE DROPS**

|    |     |     |     |     |     |     |    |      |      |      |
|----|-----|-----|-----|-----|-----|-----|----|------|------|------|
| R" | 3/8 | 1/2 | 3/4 | 1   | 1 ¼ | 1 ½ | 2  | 2 ½  | 3    | 4    |
| Kv | -   | 3,5 | 6,5 | 9,5 | 19  | 25  | 45 | n.d. | n.d. | n.d. |

$$\Delta P [\text{mm H}_2\text{O}] = 10.000 \times \left[ \frac{G [\text{mc/h}]}{Kv} \right]^2$$

